

ZONE		REV	DESCRIPTION	DATE	APPROVED
A			ECO 055 NEW RELEASE	3/8/2011	RDH
B			ECO 078, ADD ITMS #15, #16, FLIP ONE LINK OF CHAIN	5/4/2011	RDH
C			ECO 117, ADD ITMS #16 AND #17	11/28/2011	RDH

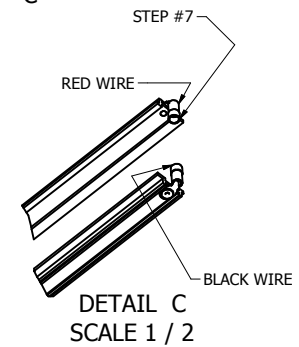

INSTRUCTIONS TO BUILD THIS ASSY FROM MODIFIED ASSEMBLIES:

- UPPER CHARGE STRIP ASSY, ITEM #1, REMOVE TWO RIVETS THAT ATTACH RING-TERMINALS TO CHARGE STRIP ASSYS. REMOVAL BY DRILLING, CUTTING IN TWO, OR ANOTHER METHOD AT ASSEMBLER OPTION--DON'T DAMAGE THE CHARGE STRIPS.
- UPPER CHARGE STRIP ASSY, ITEM #1, ON BOTH ENDS WHERE RIVETS HAD BEEN REMOVED THAT ATTACHED CABLES, CUT PLASTIC BACK ABOUT 1/2", THEN BEND OVER THOSE TWO ENDS TOWARD WHAT WILL BE THE INSIDE OF THE TRACK, (SEE PICTURE).
- UPPER CHARGE STRIP ASSY, ITEM #1, SLIDE A 1/2" LONG PIECE OF SHRINK TUBING, ITEM #3 OVER THE TWO CONNECTORS THAT HAD BEEN REMOVED FROM ITEM #1 IN STEP #1.
- USE NEW RIVET, ITEM #4 TO REINSTALL THESE CONNECTORS TO THE CHARGE STRIPS.
- USE HEAT TO SHRINK THE TWO PIECES OF SHRINK TUBING AROUND THE RIVETS, AS CLOSE TO THE METAL CHARGE STRIP OF ITEM #1 AS POSSIBLE.
- LOWER CHARGE STRIP ASSY, ITEM #2, CUT BOTH METAL CHARGE STRIPS AND PLASTIC HOLDERS (FLUSH) TO A LENGTH OF 23.5±0.25 INCHES. DEBURR SHARP CUT EDGES OF METAL STRIPS.
- LOWER CHARGE STRIP ASSY, ITEM #2, CUT SHORT-WIRE WITH MALE CONNECTORS OFF, CUTTING AS CLOSELY TO THE BENT TERMINALS AS POSSIBLE TO PREVENT ANY SHORTING RISK.
- LOWER CHARGE STRIP ASSY, ITEM #2, BEND TWO TERMINALS 'IN' TOWARD WHERE THE TRACK WILL BE.
- UPPER CHARGE STRIP ASSY, ITEM #1, CUT THE TWO WIRES OF THE SHORT-MALE CONNECTOR-CABLE ABOUT TWO INCHES FROM THE RING TERMINALS THAT YOU COVERED WITH HEAT SHRINK IN STEP 5. STRIP ABOUT 1/4" OF INSULATION FROM ALL FOUR ENDS OF THE WIRES THAT YOU JUST CUT AND INSTALL THE BUTT-CONNECTORS ITEMS #5 WITH THE WIRES IN A 'Y' AS SHOWN IN THE WIRING DIAGRAM ON THIS PAGE. REMOVE THE MALE CONNECTOR FROM THE CABLE TO THE UPPER TRACK SECTION AND INSTALL FEMALE CONNECTOR WITH MALE PINS, ITEMS #14 AND #15.
- BUNDLE THE LONG CABLES BACK UP AND ASSEMBLE THE MECHANICAL PARTS, ITEMS #6-#16 AS SHOWN.

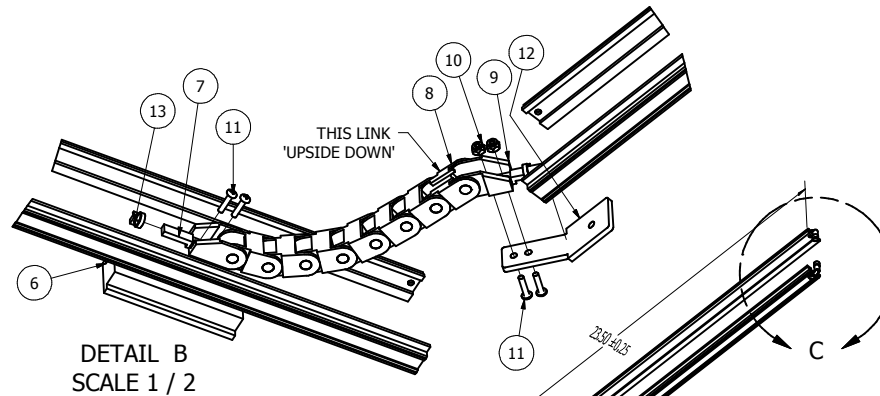
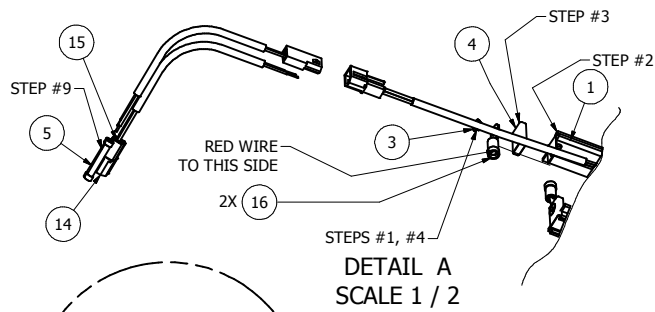
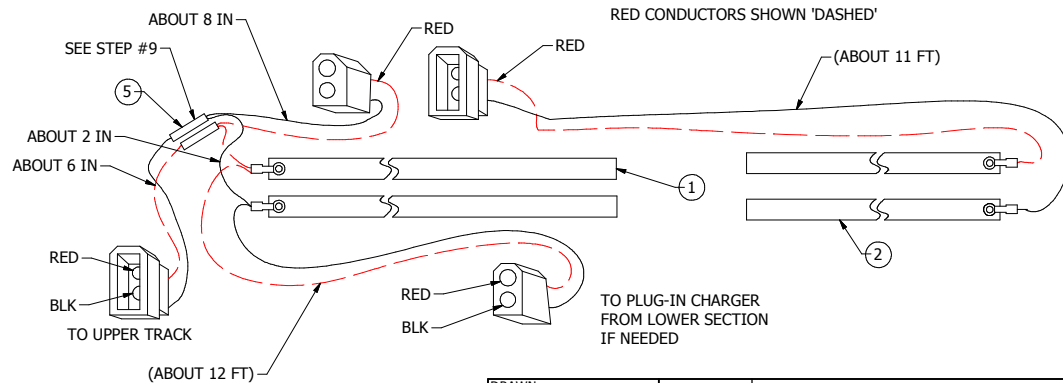

ITEM	QTY	PART NUMBER	DESCRIPTION
1	1	79130	ASSY, CHARGE STRIPS, UPPER
2	1	79131	ASSY, CHARGE STRIPS, LOWER
3	4	10715	Pop Rivet, .125 x .315
4	2 IN	16267	TUBE, SHRINK, 1/2" NON ADHESIVE
5	2	16031	Connector, Butt, 16-14, Blue
6	1	75203	SLIDER, INSIDE-TRACK WIRE CARRIER, PFT
7	1	14000-B	Igus Chain, Female, Stationary
8	1-FT (7 LINKS)	16024	Chain, Igus
9	1	14000-A	Chain, Igus, Male, Moving End
10	2	10001	Nut, Nylon Lock, 4-40
11	4	10004	Screw, 4-40x1/2, Ph-PN-MS-ZP
12	1	75204	BRACKET, CABLE SLIDER, PINN FLD TRK
13	2	10091	WIRE, TIE, .094 X 6.1
14	2	16021	MX, FEM PLUG, 2-Pin W/O EARS
15	4	16017	MX PIN, MALE, .062
16	4	10112	Terminal, Ring, 3/16, Blue

DRAWN
bob.hrenchir
3/8/2011
CHECKED

This document is the property of Harmar and is delivered upon the express condition that the contents will not be disclosed or used without the written consent of Harmar.

THIRD ANGLE PROJECTION



Tolerance UNO
X ±.1
.XX ±.01
.XXX ±.005
Holes ±.005
Ang ±.5°

Harmar 18505 E. 163rd St.
Lake Winnebago, MO 64034
816-537-0611

TITLE
ASSY, CABLE SLIDER, PINN FLD TRK

SIZE C	FINISH	DWG NO 79201	REV C
SCALE	SHEET 1 OF 1		